

Notes

- BEFORE CLOSING THE DOOR, test new combination numbers for several times by locking methods. If there are any mistakes in establishing new combination numbers, please contact an accredited locksmith.

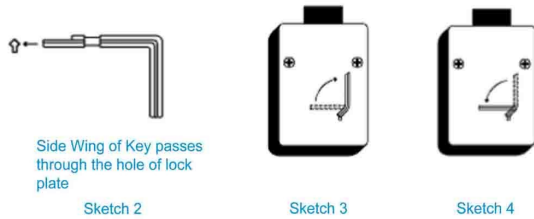

GLOBAL LEADER IN SAFE HANMI SAFE

INSTRUCTIONS

FOR CHANGEABLE COMBINATION LOCKS



This direction are used only for “LEFT” side operation and Counterclockwise turn.

- Read these directions carefully before operating and changing this combination lock.
- On the upper part of turn plate, there are two indication lines to be used for adjusting number. The central indication line is used for normally turning and unlocking lock, and the side indication line is used only for establishing codes.
- This lock is very precise and so the adjustment of combination number and indication symbol should be operated carefully. Turn plate should be slowly and stably turned. After correctly revolving circles, if there is any number that is turned far away from indication lines, a set of combination numbers should be returned. **“Do not turn backward to obtain a properly adjusted number again.”** When a selected number is adjusted to an indication line, it could be called a circle

Unlocking numbers established by factory

After having passed final test and before leaving factory, this lock has its three sets of numbers established as 50,25,50 and so this lock should be unlocked by the said three sets of combination number

- When 50 is adjusted to unlocking indication line, dial should be turned to the **LEFT** for four circles.
- When 25 is adjusted to unlocking indication line, dial should be turned to the **RIGHT** for three circles.
- When 50 is adjusted to unlocking indication line, dial should be turned to the **LEFT** for two circles.
- A. For the lock without concealed button, dial is slowly turned to the **RIGHT** till ceasing.
B. For MY -2102 with concealed button, turn the dial **RIGHT** to '15' and push head of the dial. Then, keep slowly turning the dial to the **RIGHT** till ceasing.

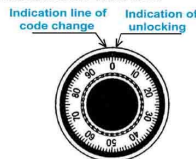

- Key Function (for Model MY 8617,MY8618 with key hole on the dial)
When either of 0, 25, 50 and 75 is adjusted to the unlocking indication line, the function of the combination lock could be stopped by locking the key - lock on the dial

Locking

Turn plate should be turned to the left at least for four circle.

Change of established numbers

Freely select three sets of established numbers, but the numbers from 0 to 20 should not be used as the final set of numbers, for example, 52, 86 13.

For strict security, 0 or 5 should not be used as the final number, and mean while up - style and down- style combination numbers should not be used, for example, 32,48,74, or 74,48,32.

- As mentioned in the foregoing explanations 1,2,3, turn the present existing combination numbers and adjust them to the indication line of code change.
- Set final set of number at the indication line of code change by turning plate, and meanwhile insert a code change key (see sketch 3) into the lock hole which is on the lock's back until side wing has completely entered into hole (see sketch 2).
- In order to establish new combination numbers, turn key to the **LEFT** at 90 degree (see sketch 4).
- As mentioned in the foregoing explanations 1,2,3, of unlocking methods turn newly established numbers on the turn plate, and then adjust them to the indication line of code change.
- Set final set of number at the indication line of code change by turning plate. Turn code change key to the **RIGHT** at 90 degree (see sketch 3) and then taken out the key. Therefore, the newly selected combination numbers have been completely established in the lock.