

* You are able to identify the status used it more than tentimes when you press "#". You will return to change mode when you press "0"
 The method for identifying usage
 Digit - The user who has opened the door
 Capital Letter - The users from 1 to 5 (from A to E) was input
 Small Letter - The users from 2 to 5 (from b to e) was deleted
 0 - The safe was opened with the factory code
 X - (english character) - There were 3 wrong attempts
9 - DELETE LOG (The function for deleting the button users)
 Press "9" at the 0 - EXIT (1 = YES or 0 = NO)
 SUCCESS When you push "1"
 9 - DELETE LOG When you press "0"
 In case the "EMPTY LOG ..." was shown, it means that all data were deleted.

GLOBAL LEADER IN SAFE
HANMI SAFE

INSTRUCTIONS

FOR DIGITAL LOCK SYSTEM

THE TIMER FOR CHANGING BATTERY

In case the safe doesn't open, even if the melody along with LED was shown. The battery need to be replaced immediately. The 6V of direct current adapter is available if there is no battery.

* NOTICE

If you make a mistake entering the personal code. ERROR will appear on the display. After 3 wrong attempts."PLEASE WAIT.." will appear on the display for 15 minutes and it can not be used the while.

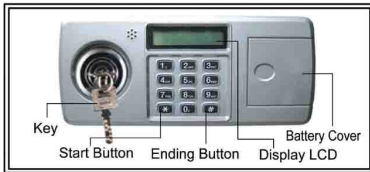
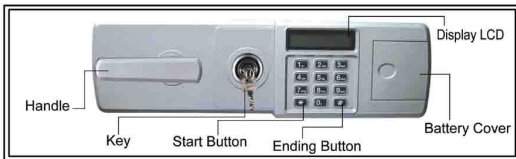

Thanks for your choice on the digital lock designed
 In order to make the best use of digital lock, please observe the following rules

TO OPEN SAFE

- Insert 4 units of 1.5V battery after opening the cover of battery
- STEP 1 : Press start button "*" "
- STEP 2 : Enter Personal code given by the manufacturer
- STEP 3 : Press the button "#" in the end
- STEP 4 : Turn knob(key) to the right and open the safe with :Match" on the LCD.

TO CHANGE PERSONAL CODE

Convenient change of the master code
 (The master code could be changed in the status of opening the safe).
 Reference : The personal code could be input from 4 digital to 16 digit.

- STEP 1 : Press button "M" for changing inner number (NEW PW)
- STEP 2 : Enter the new personal code (ex : 5555)
- STEP 3 : Press the button "#" for the end (SUCCESS)

* Just a Moment

Close the safe after identifying " MATCH " by pressing " * 5555# " in sequence

CHANGE OF PERSONAL CODE ON THE CHANGE MODE

- STEP 1 : Press start button "*" "
- STEP 2 : Enter end button "#"
- STEP 3 : Press master code (ex : 4 5 6 0)

- STEP 4 : Press "#"
- STEP 5 : Change Mode "0 - EXIT" will be shown on the LCD
- STEP 6 : Press "1" (C-NO : 1..) at this moment, Choose one personal code by pressing the subsidiary channel " 2,3,4,5 ex 7777 # (RETYPE NEW PW :)
- STEP 7 : Enter new personal code and then press "# " EX) 7777# (RETYPE NEW PW :)
- STEP 8 : Enter new personal code again and then press "# " (EX:7777#)
- STEP 9 : The perfect confirmation of input will be shown (completion : SUCCESS ! Failure : ERROR!)
- STEP 10: Try from step 1 again if failure

FUNCTION MODE

Repeating numbers will be shown on the LCD as below when you Press "# " on the 0-EXIT of : "Change Mode"

- 0 - EXIT (Change Mode)
- 1 - CHANGE PASSWORD (For changing password)
 The customer's personal code from channel 1 to5 are available.
- 2 - DELETE PASSWORD (For Deleting password)
 . Channel 1 as the master code couldn't be deleted but can be changed
 . Channel 2 to 5 could be deleted
- STEP 1 : Press " 2 " on change mode (DELETE NO : 2,3,...)
- STEP 2 : Press the channel you want to delete (1 = Yes or 0 = No)
- STEP 3 : To delete Press "1", To cancel Press "0"
- STEP 4 : It will be shown on the LCD at change mode (2 - DELETE PASSWORD)
- 7 - DISPLAY MODE (The Function of Hiding Personal Code)
 . To Hide : Press "7" again at the 0- EXIT (DISPLAY HIDE) EX)4560 ->*****
 . To Cancel : Press "7" again at the 0-EXIT (DISPLAY NORMAL) EX)****-> 4560
- 8 - VIEW LOG (The function for identifying the button user)

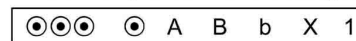

- The Safe was opened with master code
- There were 3 wrong attempts
- The No.2 user was deleted
- The No.2 user was input
- The master code was changed
- The safe was opened with the factory code